

- (d) Disengage the roof wire from the claw of the room light.
- (e) Using a screwdriver with its tip wrapped in protective tape, disengage the 4 claws and remove the room light switch base.
- (f) Remove room light bulb No. 1.

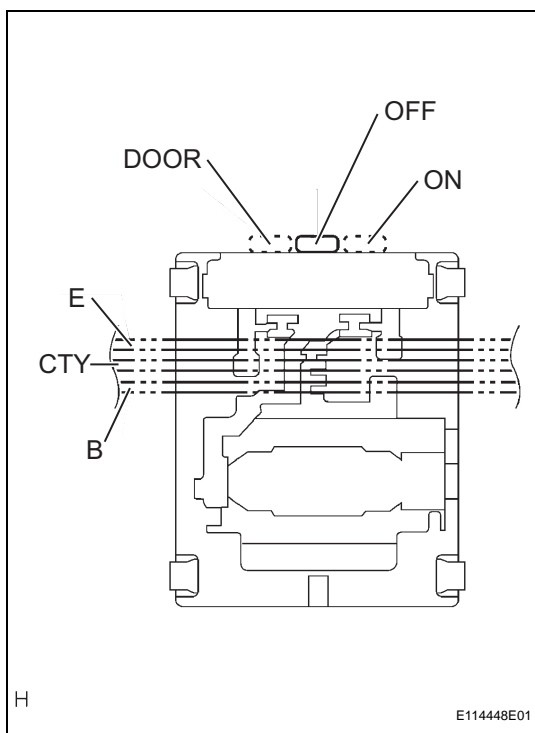

INSPECTION

1. INSPECT ROOM LIGHT ASSEMBLY

- (a) Check the resistance.
 - (1) Using an ohmmeter, measure the resistance and check the results in accordance with the value(s) in the table below.

Standard Resistance

Tester Connection	Condition	Specified Condition
-	OFF	10 k Ω or higher
CTY - B	DOOR	Below 1 Ω
B - E	ON	Below 1 Ω

If the result is not as specified, replace the room light.

- (b) Check the light operation.
 - (1) Connect the positive (+) battery lead to terminal B and the negative (-) battery lead to terminal CTY, then check that the light illuminates when the switch is in the DOOR position.

Standard:

Light illuminates.

If the light does not illuminate, replace the bulb.

- (2) Connect the positive (+) battery lead to terminal B and the negative (-) battery lead to terminal E, then check that the light illuminates when the switch is in the ON position.

Standard:

Light illuminates.

If the light does not illuminate, replace the bulb.

INSTALLATION

1. INSTALL ROOM LIGHT ASSEMBLY

- (a) Install room light bulb No. 1.
- (b) Engage the 4 claws and install the room light switch base.
- (c) Install the roof wire into the claw of the room light.

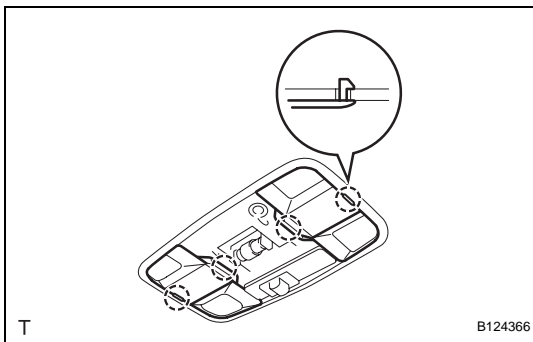
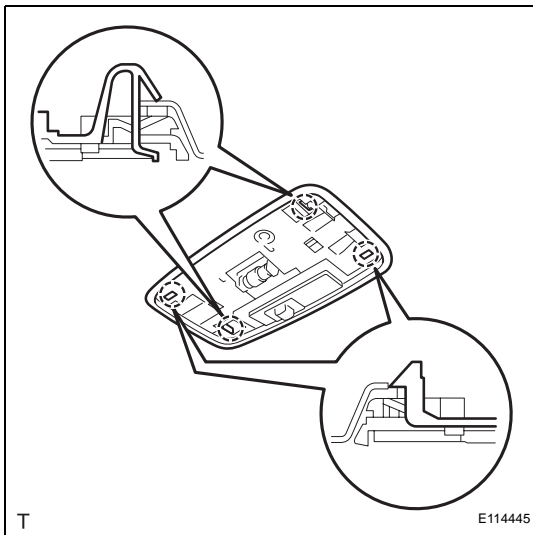
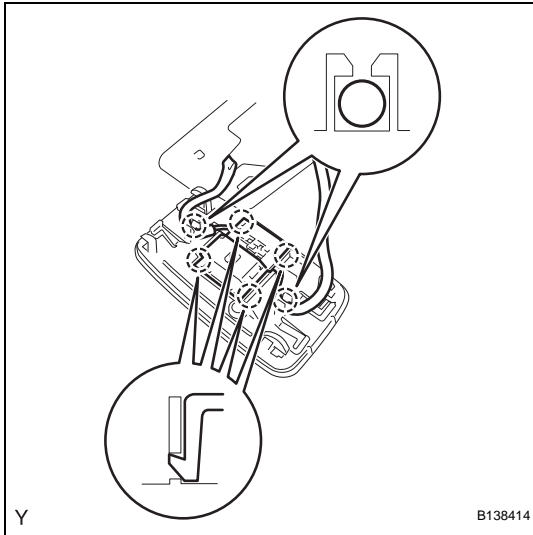

- (d) Engage the 4 claws and install the room light.



- (e) Engage the 4 claws and install the 2 covers.

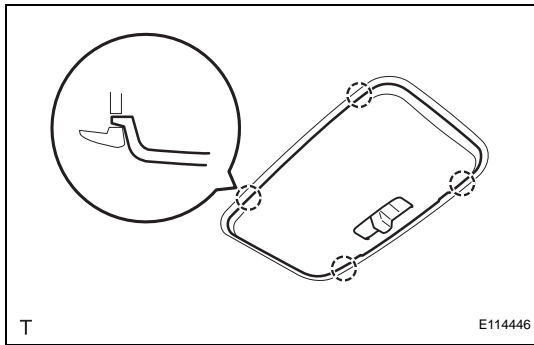

(f) Engage the 4 claws and install the room light lens.

2. CONNECT CABLE TO NEGATIVE BATTERY TERMINAL

Torque: 3.9 N*m (40 kgf*cm, 35 in.*lbf)